

## SHIELDED CABIN – RADIOSCOPIC SYSTEM



- Shielded cabin fully satisfy the requirements of the DIN 51113, CFR 1020 and of the next requirements for radiation safety.
- Is suitable for operation with X-ray sources up to 200kV.
- Large service door.
- The various X-ray sources and image intensifiers as well as wide scale of accessories could be pleased it the large internal area.
- Ionising radiation is signalled by red warning light.
- For the mass-production the tested part automated movement is possible (as special option).

### Basic technical data:

SHIELDED CABIN		
Outline dimensions	[mm]	1800 x 1805 x 860 (w x h x d)
Weight	[kg]	cca 1600 kg
Doors		1x work (1010 x 500), 1x service (1700 x 800)
Work (shielded) area	[mm]	1700 x 1700 x 800 (w x h x d)
Tested part dimensions (max.)	[mm]	max. Ø 500, height 1000, max. 200kg
Shielding material		sandwich Pb / steel
Maximal shielded energy	[kV]	200
Power supply		230V, 380V, cooling medium

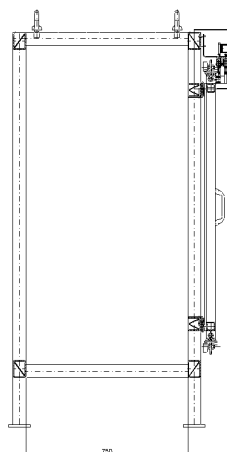
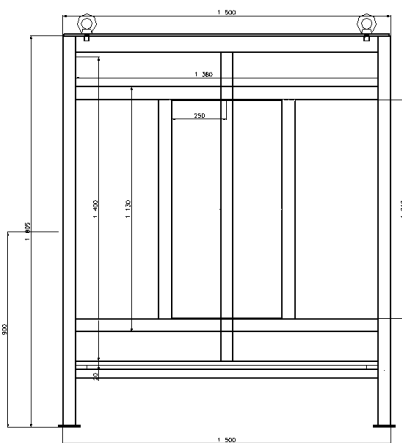

## Specification of the typical RS system configuration:

### HV GENERATOR BALTEAU XSD 160

High stabilised HF generator

Fluent voltage set-up

[kV] 5 –160

Connector

standard HV connector



### DIRECT X-RAY TUBEHEAD BALTEAU TSD 160/O

Metal-ceramic

Accelerating voltage

[kV] max. 160

Two focal spots – Dimensions (acc. to IEC336)

[mm] 0,4 x 0,4 a 3 x 3

X-ray output area - conus

[°] 40 grades



### X-RAY GENERATOR CONTROL UNIT BALTEAU LS 1

Voltage set-up step

[kV] 1, 2 a 5

Current set-up step

[mA] 0,1 , 0,2 a 0,5

Internal memory

[mm] 10 000 positions, folder system



### IMAGING SYSTEM

Image intensifier BIX 223CT/00

Acquisition and processing SW IPS 011

Power-supply and control unit BIX-CTR-DL



### 5 - AXIS MANIPULATOR

5-axe manipulator (robot) ATG with control.

As an option is possible add SW for movement automation.

Typical load

[kg] 20

Horizontal movement (axe X), stroke

[mm] +/- 200 mm

Horizontal movement (axe Y)

[mm] +/- 200 mm

Stroke of the rotary desk

[mm] +/- 200 mm

Rotation – continuous

[°] 360

5<sup>th</sup> axe tilt

[°] +/- 30 grades



### ACCESSORIES

Build-in X-ray system, source holders and intensifier holders

Orange and red safety light

Labyrinth, cables, cooling medium distribution system.

**Provozovna a korespondenční adresa/Office and shipping address:**

**ATG, s.r.o**

Beranových 65

199 02 Praha – Letňany

Czech Republic

Tel.: +420 234 312 201-4

Fax: +420 234 312 205

E-mail: atg@atg.cz

<http://www.atg.cz>

ISO 9001 Certified Quality Management System.

